



Paper | 08-06-2017

WHAT FILE TYPES IS OFFERED ON MEPCONTENT?

This paper is a reflection on the BIM Insights session webinar 'MEP engineers: what file types/content is offered on MEPcontent?'. The webinar took place on June 8th 2017.

In this paper you will learn:

- what file types MEP engineers and designers use
- what the content factory does to upgrade manufacturer content (according to the European MEP Content Standard, EMCS)
- what quality control checks are made to ensure that users have reliable and accurate content

Stefan van Eerde
Sr. Product Marketer







Jaap Groen
Product Marketer



Coert de Jong
Product Manager



MEPcontent

-  Uniform Revit models
-  22,000+ MEP engineers
-  270+ manufacturers
-  500,000+ articles
-  Global
-  EMCS standard

ABOUT MEPCONTENT

MEPcontent is the place to be for free content for Revit and AutoCAD as well as IFC files. Together with leading manufacturers globally, we strive for the widest possible range of MEP articles on the website. The quality of the content is of great importance not only for the manufacturer, but definitely for the engineer to make sure you have access to small sized, workable content which is easy to replicate in your projects.

MEPcontent

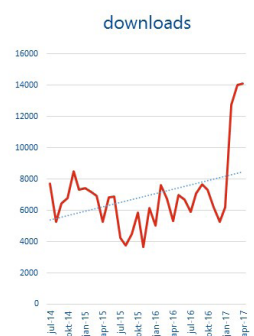
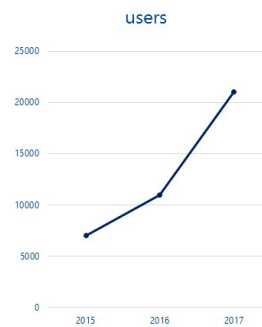

Key statistics for MEPcontent

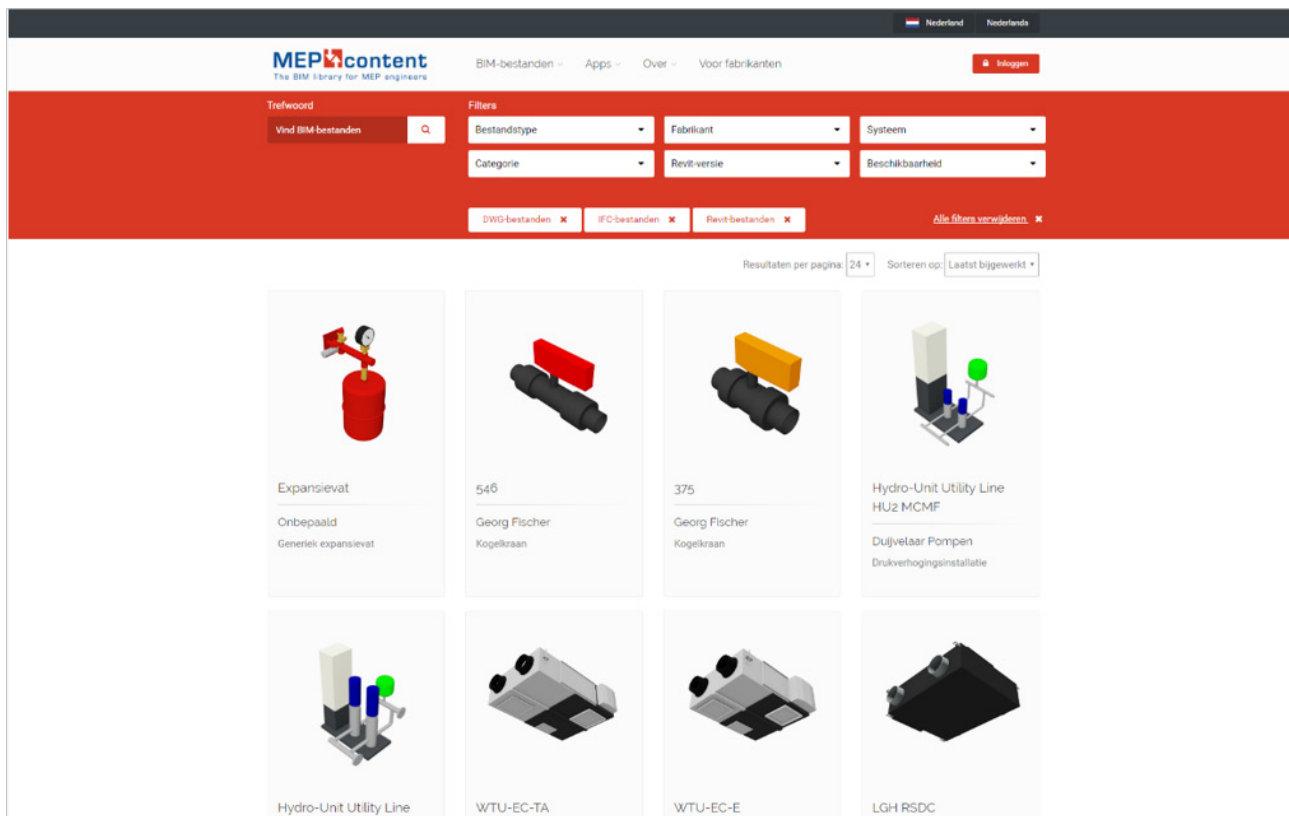

MEPCONTENT.COM

For those of you who are not that familiar with MEPcontent, an overview of the MEPcontent site is shown at the top.

Our platform MEPcontent.com offers BIM files from all major manufacturers in MEP engineering from all around the world. The content can be used in both Revit and Cad software directly and can be downloaded for free once you have created an account.



CONTENT IS EVERYTHING

What is data? What is content? Well, we know that content is everything.

Why? Because content is a type of representation of data that allows you to use the data in your projects and to help you with your project modelling, forecasting and project definition.

3D content from manufacturers provided by MEPcontent helps you to work with real-life articles which you can use in your projects and put on your bill of materials so that you know what you require for each project.



270+ MANUFACTURERS

The content we offer on the platform is provided by over 270 manufacturers and this number is constantly growing.

The content provided by manufacturers is adjusted and enriched by the MEPcontent content factory to give the engineers an optimal user experience and to make sure it does comply with high quality standards (such as EMCS). And of course, it is aligned with the manufacturers to make sure the BIM files represent the actual articles available at the wholesaler or manufacturer.



500,000+ PRODUCTS

In the MEPcontent BIM library you can browse through more than 500,000 MEP products. From electrical to mechanical, heating and cooling products and many other MEP sub-domains and categories.

500,000 products with a lot of data attached to it. That is our own example of big data relevant to engineers today. And we will continue expanding the relevant data in the MEP domain by offering more content from the manufacturers who currently cooperate with us and to expand the number of manufacturers.

We focus on quality data and only on the MEP domain to make sure the overview of content you get is absolutely relevant to you without things you as a MEP specialist don't care about like walls, chairs or tables.

BIM content requirements

- Compact content (small in size)
- Right and correct data
- Easy to use and maintain
- Deeplinks to documentation
- Complies to BIM standards
- Easy to find



BIM CONTENT REQUIREMENTS

Ok, what is important when you look at BIM content?

First of all, the content must be workable. Small in size and accurate enough (without too many details) to be used in your Revit or Autocad project.

Second, it must be a correct representation of the real thing.

Third, you as engineer must rely on content that is up-to-date and well-maintained.

Fourth, you want to get access to the underlying data behind the BIM model by having working links to additional documentation

Fifth, it must be interoperable and in line with BIM standards

Sixth, you need to have all the content you need in one place. One single BIM library, such as MEPcontent.eu

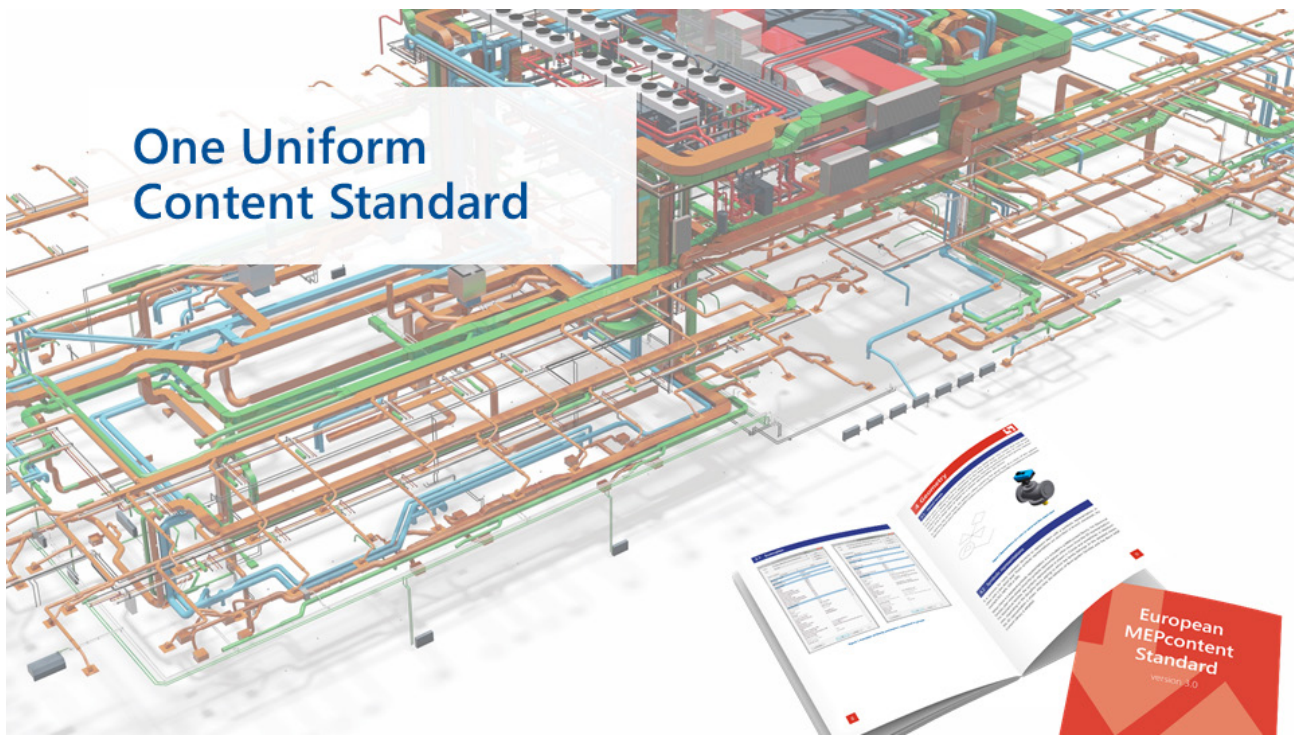

EMCS: ONE UNIFORM CONTENT STANDARD

The European MEPcontent Standard (EMCS) has been prepared by Stabiplan to provide MEP engineers throughout Europe with a clear understanding of the need for high quality and uniform content. I.e. graphical article information

The document also represents Stabiplan's vision for the future. We want to share our knowledge on MEP and content for MEP because we know that MEP is a dedicated business that deserves its own standard. Ideally, a standard that is globally accepted or at least not country specific but applicable in larger regions, such as Europe.

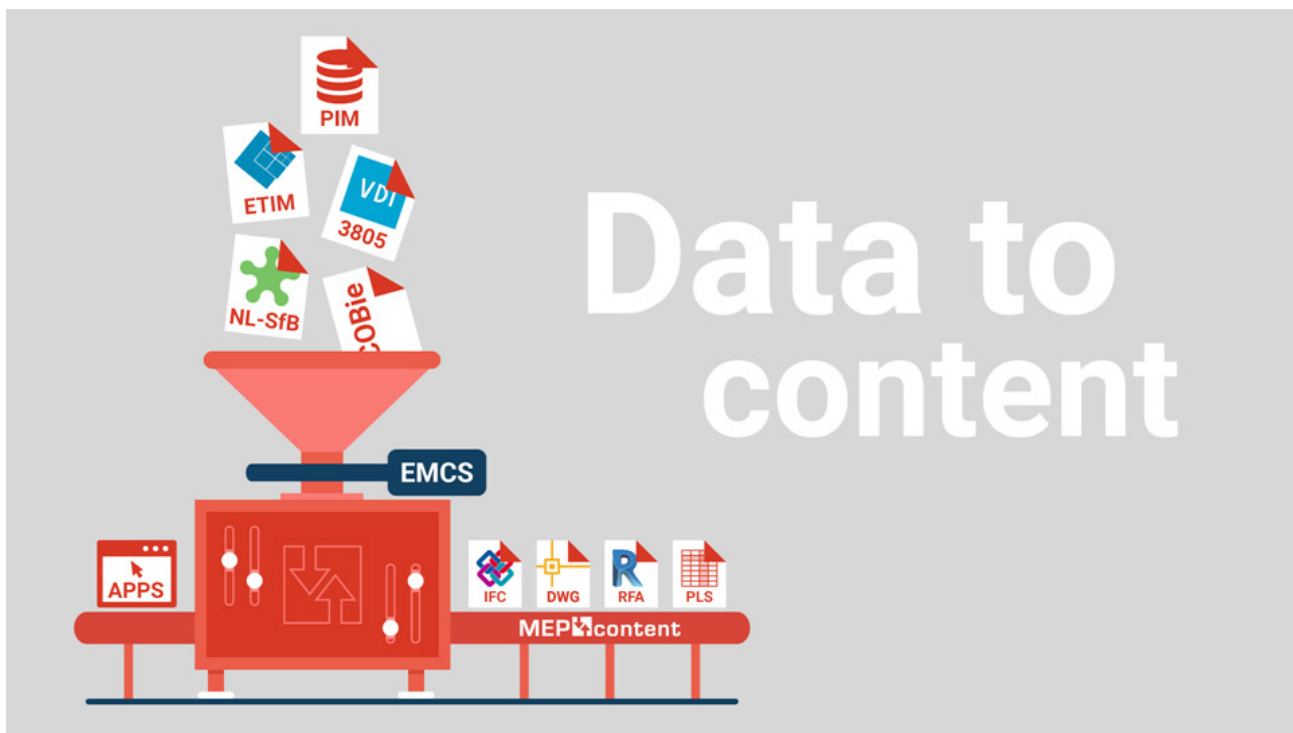

WHAT IS GOING ON IN THE CONTENT FACTORY?

How is all this data processed?

And what output do you get from all the data provided by manufacturers?

Lets go to a demo to understand what the content factory does.

Coert de Jong, Product manager working for MEPcontent, shares with you what he does at the content factory.



CONTENT FACTORY

First of all, content can be triggered in three ways.

1. The customers, such as engineers, who require certain BIM content (data) for the apps they want to work with or software they use.
2. Manufacturers who want to share their (new) content with engineers and designers all around the world.
3. Project can be the trigger as well (in a certain project it is outlined that content, for instance generic content, must be used with pre-defined parameters and product characteristics).

These triggers result in a content request, which can be addressed by the support team or sales team. The content factory team prepares a time estimate detailing the number of hours needed to enrich the content, adjust the data to match the needs of engineers, localization (every country can have it's own offering) and quality control.

When the time estimate is approved, the content can be created, tested, reviewed and finally be published on the MEPcontent platform and be made available for apps such as the SANHA Product Line Placer (for SANHA content) or ABB Busch-Jaeger Switch Range Configurator (for ABB Busch-Jaeger content).

And when all is published the marketing team takes over and announced the new content in newsletters, on the MEPcontent website and through other channels to make sure engineers and designers hear about it.

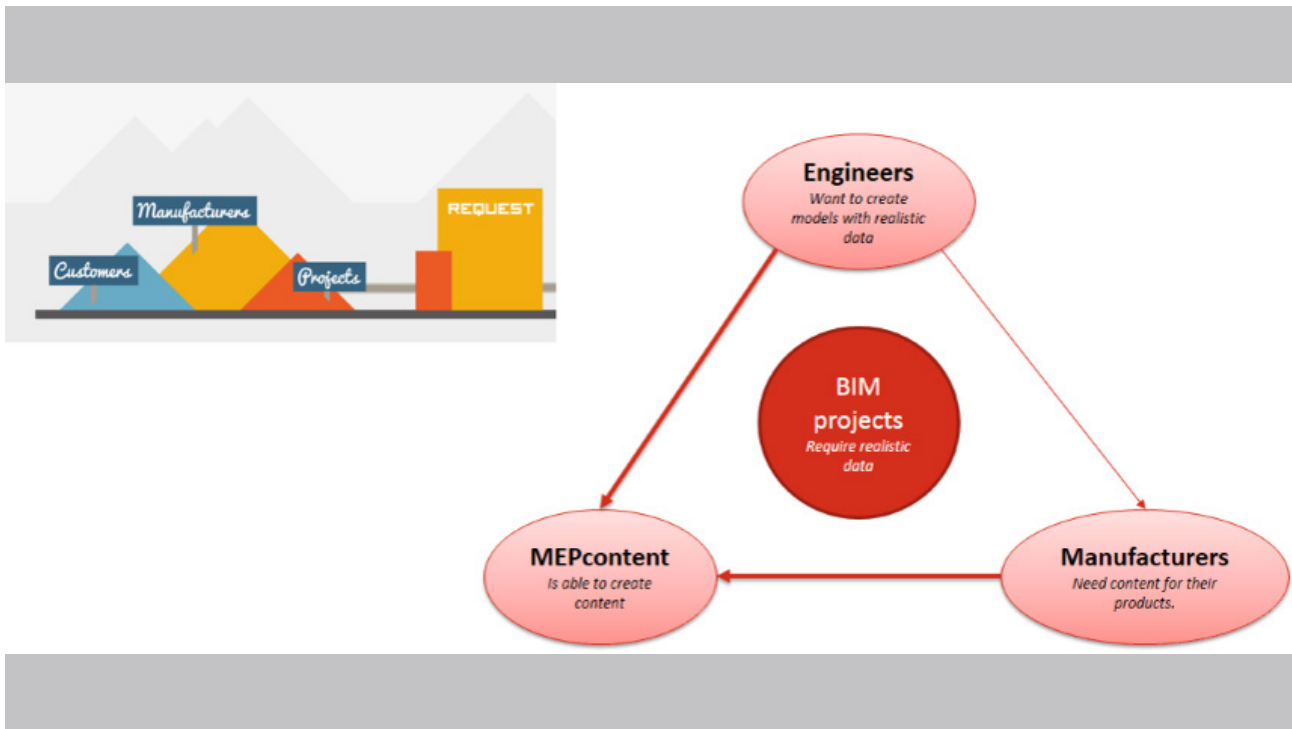

CONTENT REQUESTS

This schematic overview shows the connection between engineers, manufacturers, MEPcontent and the BIM projects in the centre of the process.

Engineers are often the ones who request content either by contacting MEPcontent or by contacting the manufacturers. Manufacturers ask MEPcontent to create the relevant content (either triggered by requests from engineers or through other events such as new product releases, product updates or expansion of the product offering to other countries or regions).

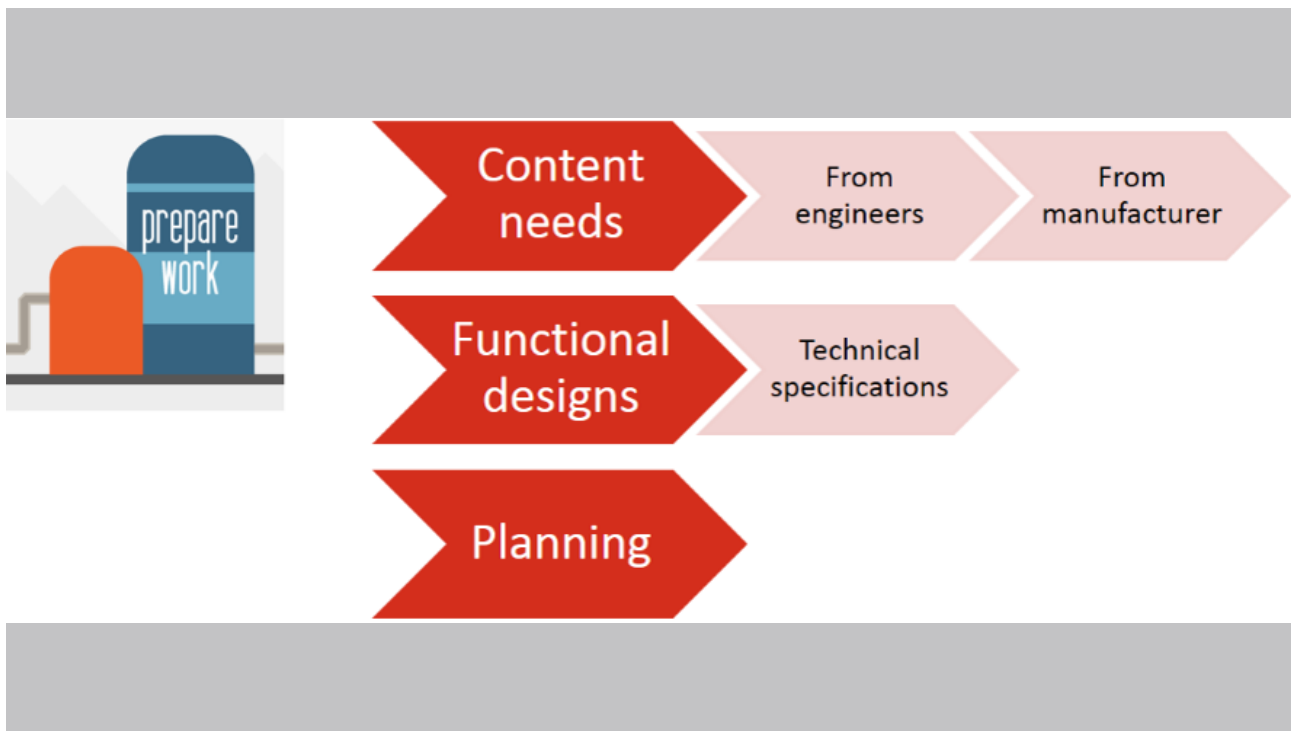

CONTENT FACTORY

Content needs result in Functional designs being made (including the technical details about what the content should contain), leading to a time estimate and planning which is effectuated in our agile methodology, using sprints to generate content to be able to work together with engineers and designers and to produce content as fast as possible.

Of course the time of delivery mainly depends on the approval of the manufacturer (only after approval the content can be created) and the time it takes before the 'raw materials/data' is provided by the manufacturer to the content factory team.

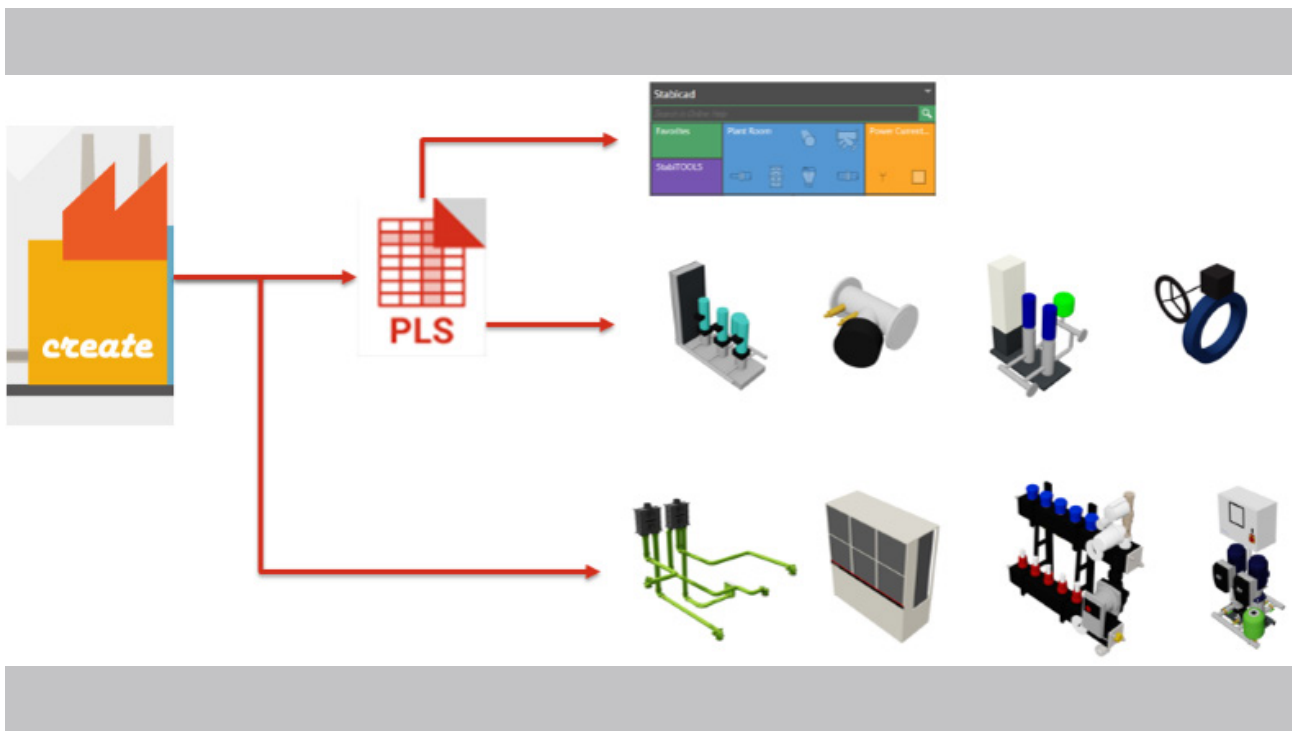

CONTENT FACTORY

So how does the content creation process look like?

In the heart of the content creation process, you can see PLS. PLS means Product Line Sheet which is an overview of parameters in excel providing all the relevant parameters and details such as sizes, costs, article numbers, deeplinks and many more information about the content family.

The PLS feeds into Stabicad, the advanced MEP software from Stabiplan. PLS is also the cornerstone of 3D models published on the MEPcontent platform.

Next to PLS files, it is also possible to create the BIM models directly in the required file types such as DWG, RFA and IFC.

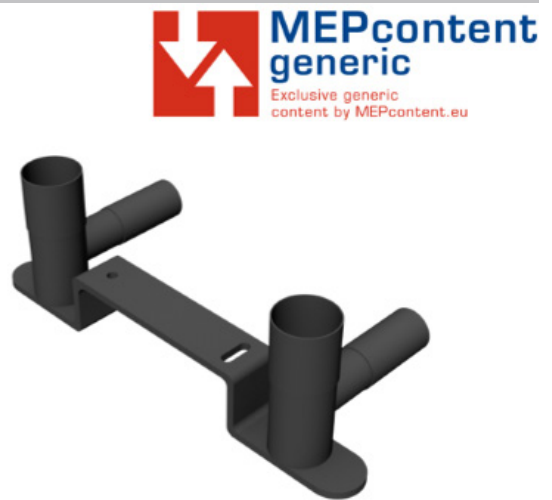
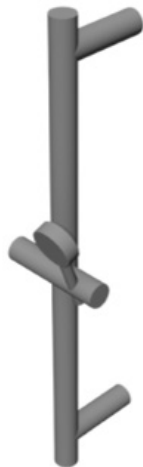

GENERIC CONTENT

Next to manufacturer requests, the content factory also addresses requests from engineers and designers directly by offering MEPcontent generic content.

This is content without a link to a specific manufacturer which can be used for free in cases where a project requires generic content (for instance due to legislation in certain countries) or in case certain objects are not provided by manufacturers.

Think of vessels, vaults, meters, wall-plates, ducts and pipes.

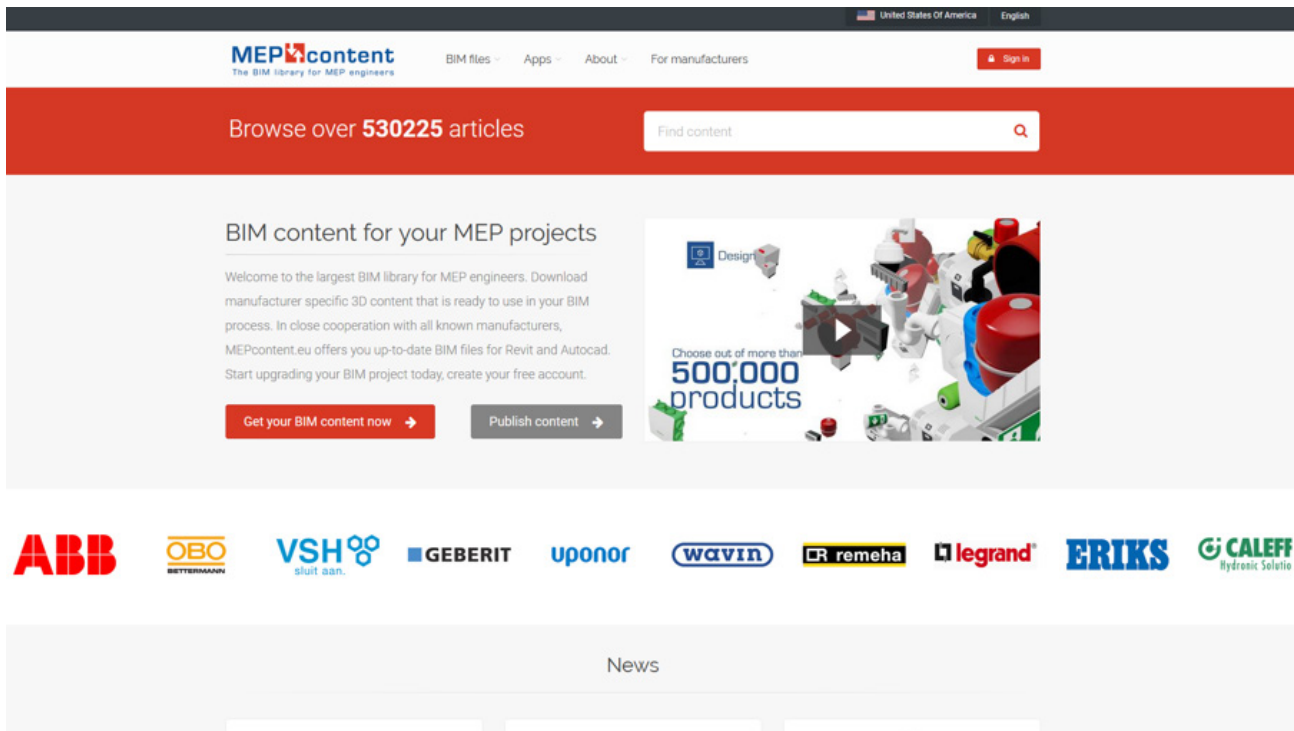

MEPCONTENT.EU

You can create your free account by pressing on the red button in the top right corner on the MEPcontent website in order to download the content you need.

You can find all the content from within the apps (the apps can be downloaded from <https://store.mepcontent.eu/>) and if you want to get access to the models directly, you can click on the search field to find the content you need.

Or click on the 'BIM files' caption on the website <https://www.mepcontent.eu/>.

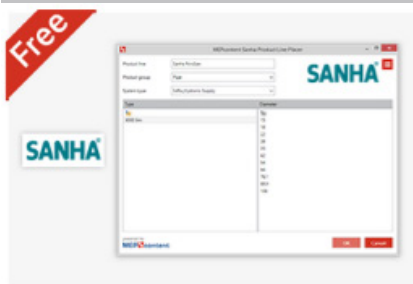

SANHA Product Line Placer for Revit



ABB Switch Range Configurator

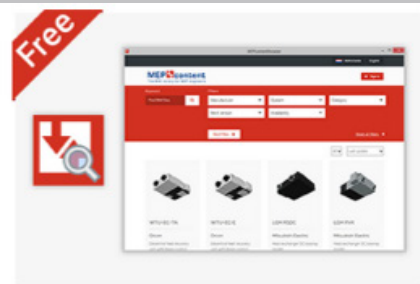

MEPcontent Browser

Download for free on:

store.mepcontent.eu →

START USING OUR APPS TODAY

With your account you cannot only download 3D content for free, but you can also download and install these three apps for free.

The apps can be found on <https://store.mepcontent.eu/> and are connected to the 3D content available on the MEPcontent platform.

Some apps are manufacturer specific, such as the SANHA Product Line Placer you see on the left, or the ABB Busch-Jaeger Switch Range Configurator in the middle. Some are more generic, such as the MEPcontent browser on the right, to find all Revit and AutoCAD files from within your project software environment without having to leave Revit or AutoCAD.

June 22nd 2017 12:00-12:30 CET

Co hosted by Mitsubishi Electric



NEXT WEBINAR

Thank you for reading this paper. The next webinar we host will be in cooperation with Mitsubishi Electric on June 22nd 2017.

To watch the webinar related to this paper, other interesting BIM Insights Sessions webinar recordings or BIM videos, please go to <https://www.mepcontent.eu/video/>

We hope to see you at one of the following webinars we host for you in 2017.



Want to join the next webinar?
mepcontent.eu/events

**HAVE ANY QUESTIONS?
CONTACT US:**

☎ +31 172 63 00 29
✉ INFO@MEPCONTENT.EU
🌐 WWW.MEPCONTENT.EU

© 2017 Stabiplan International BV

MEPcontent is a registered trademark of Stabiplan International BV. All other brand and product names are (registered) trademarks of their respective holders.